

EAGLE

HT FIFTH WHEELS

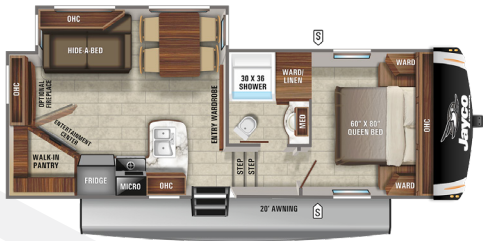

24RE A, B, C, E, G

Ext. Lgth: 29' 2" Weight: 7,980 lbs. Hitch: 1,495 lbs.

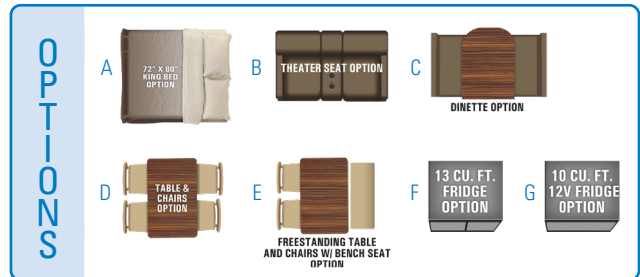

25.5REOK A, B, C, E, G

Ext. Lgth: 29' 2" Weight: 8,290 lbs. Hitch: 1,440 lbs.



27RS A, C, E, G

Ext. Lgth: 32' 8" Weight: 8,950 lbs. Hitch: 1,675 lbs.



28.5RSTS A, C, E, G

Ext. Lgth: 32' 9" Weight: 9,345 lbs. Hitch: 1,690 lbs.



30.5CKTS A, C, E, F, G

Ext. Lgth: 33' 11" Weight: 9,430 lbs. Hitch: 1,805 lbs.



29.5BHDS A, B, D, E, G

Ext. Lgth: 34' 7" Weight: 9,385 lbs. Hitch: 1,820 lbs.



29.5BHOK A, D, E, F, G

Ext. Lgth: 35' 1" Weight: 9,290 lbs. Hitch: 1,740 lbs.

STANDARDS & OPTIONS

STANDARD EXTERIOR EQUIPMENT

- StrongholdVBL™ aluminum framed and vacuum bond laminated gelcoated fiberglass exterior walls (including rear wall and slide room end walls)
- Magnum Truss™ Roof System (strongest tested roof in the industry) with one piece, seamless DiFlex II material
- Climate Shield™ zero-degree tested weather protection:
 - Fully enclosed and heated underbelly (ducted)
 - 35,000 BTU output furnace
 - Double layer fiberglass batt insulation in ceiling and floor
 - Double sided radiant barrier insulation (roof, floor, and behind cap)
 - PEX plumbing
- HELIX Cooling System™ (industry exclusive):
 - Exterior-mounted 15,000 BTU "Whisper Quiet" A/C unit
 - Jayco exclusive insulated dual duct design
 - Directional and closeable A/C vents
 - Larger return air vents with user accessible filters
- JaySMART™ (Safety Markers And Reverse Travel) LED lighting (patent-pending)
- Painted fiberglass front cap with built-in specialty LED lighting
- Custom automotive-grade vinyl exterior graphics package
- LED exterior lighting package
- Detachable shore power cord
- Dual 30 lb. propane bottles with auto regulator
- Pass-through storage with Slam-latch™ baggage doors
- Digital TV antenna with Wi-Fi prep
- Exterior marine-grade speakers
- Fully enclosed, LED-lighted universal docking center:
 - Selectable water connections
 - Quick-connect outside shower
 - Black tank flush, winterization, and sanitization
 - Independent satellite and whole coach cable hookups
- Water heater bypass
- Battery disconnect
- Under-mounted spare tire (Goodyear® Endurance® - made in the USA)
- LP quick-connect (outside grill prep)
- Roof ladder
- Slide topper/awning prep
- "Industry's BEST" outside kitchen (select models)

STANDARD INTERIOR EQUIPMENT

- Solid hardwood slide fascia
- Handcrafted and glazed doors, drawers and trim
- Heavy-duty, 75 lb., full-extension, steel ball-bearing drawer guides
- 5/8 in. tongue-and-groove joined plywood floor decking

- Residential carpeting with stain guard (made in the USA) (limited areas)
- Residential vinyl flooring (made in the USA)
- Vinyl flooring in slideouts (no carpet)
- LED interior lighting throughout
- LED dimmer switches in main room and dining area
- Central command center with built-in tank monitoring
- Tri-fold hide-a-bed sofa with residential sleep surface (select models)
- Theater seating (select models)
- Stainless steel kitchen sink
- Brushed nickel kitchen faucet with pull-out sprayer
- Dual USB charging ports (kitchen and bedroom)
- Bluetooth® speaker prep
- 12V charging station
- Extra 120V power outlets in kitchen and slide rooms
- Residential quilted bedspread and pillows
- Gas-strutted under-bed storage
- Inverter pre-wire
- C.P.A.P. prepped bedroom
- Carbon monoxide and LP detector
- Bathroom skylight
- LED backlit medicine cabinet with custom framed mirror
- Bathroom tile backsplash
- Blue LED nightlights (bathrooms and bunkrooms)
- Porcelain foot flush toilet

CUSTOMER VALUE PACKAGE (MANDATORY)

- MORryde® StepAbove™ entrance steps (main entrance) with blue LED light
- 15,000 BTU "Whisper Quiet" A/C
- 50-amp service with dual A/C ducts and second A/C prep
- Electric patio awning with integrated LED lights
- 6 gal. gas/electric water heater
- Custom machined aluminum rims
- Rear 2 in. towing receiver with 4 pin connector
- Keyed-Alike™ lock system (single key for all doors/locks)
- Rooftop and ground solar prep by Go Power!®
- Observation camera prep (rear and sides)
- Hidden hinges on cabinet doors
- Upgraded friction hinge entrance door with XL grab handle
- LED HDTV with fully digital HDMI® output
- 12V A/V system with Bluetooth® and HDMI®
- Stainless steel range with glass cover
- Stainless steel microwave with exhaust fan
- Residential queen (60 in. x 80 in.) Serta® mattress with under bed storage
- Rain-proof bathroom power vent

4 STAR HANDLING PACKAGE (MANDATORY)

- Goodyear® Endurance® Tires (made in the USA, load range 'E')
- Dexter® Axles with Nev-R-Adjust® brakes and E-Z Lube® hubs
- MORryde® CRE-3000™ rubberized suspension
- Wet bolt fasteners, bronze bushings, and shock absorber prep

LUXURY PACKAGE (MANDATORY)

- Electric auto-leveling
- Turning Point™ rotational pin box
- JAYCOMMAND™ "Smart RV" System
- 8 cu. ft. gas/electric refrigerator

OPTIONS

- Dry Camping Package (generator prep & extra LP capacity)
- Wireless observation camera kit
- Tire Pressure Monitoring System (TPMS)
- Overlander Solar Kit (solar controller and roof-mounted 190W panel)
- Frameless dual-pane tinted safety-glass windows
- Canadian Standards (CSA)
- Custom contemporary or traditional interior design (industry first)
- Free-standing rustic table with leaf and bench seat, 2 storage & 2 folding chairs
- Free-standing rustic table with leaf and 2 storage & 2 folding chairs
- Booth dinette (select models)
- LED fireplace, 5,000 BTU electric heater (standard on select models)
- Wall-hugger theater seating (select models; standard on select models)
- 10 cu. ft. 12V refrigerator
- 13.5 cu. ft. gas/electric refrigerator (select models)
- 2nd 15,000 BTU A/C ducted in bedroom

NEW FOR 2021!



FLOORPLAN	EXTERIOR TRAVEL LENGTH	EXTERIOR WIDTH	EXTERIOR HEIGHT (WITH A/C)	INTERIOR HEIGHT	INTERIOR HEIGHT BEDROOM	UNLOADED VEHICLE WEIGHT	DRY HITCH WEIGHT	GVWR	CARGO CARRYING CAPACITY	FRESH WATER CAPACITY (INCLUDING WATER HEATER)	GRAY WASTE WATER CAPACITY	BLACK WASTE WATER CAPACITY	SLEEPING CAPACITY
24RE	29' 2"	8' 0"	12' 5"	8' 4"	6' 2"	7,980	1,495	9,995	2,015	87	75.5**	43	4-5
25.5REOK	29' 2"	8' 0"	12' 5"	8' 4"	6' 2"	8,290	1,440	9,995	2,015	87	75.5**	43	4-6
27RS	32' 8"	8' 0"	12' 5"	8' 4"	6' 2"	8,950	1,675	10,995	2,045	87	75.5**	43	4-6
28.5RSTS	32' 9"	8' 0"	12' 5"	8' 4"	6' 2"	9,345	1,690	10,995	1,650	87	75.5**	43	4-6
30.5CKTS	33' 11"	8' 0"	12' 5"	8' 4"	6' 2"	9,430	1,805	11,250	1,820	87	75.5**	43	4-6
29.5BHDS	34' 7"	8' 0"	12' 5"	8' 4"	6' 2"	9,385	1,820	11,250	1,865	87	75.5**	43	8-10
29.5BHOK	35' 1"	8' 0"	12' 5"	8' 4"	6' 2"	9,290	1,740	11,250	1,960	87	75.5**	43	8-9

Some specs at the time of print may include estimates, for the most updated information, please visit Jayco.com

**Indicates split tanks



TRAVEL WITH CONFIDENCE • NO ONE OFFERS A BETTER WARRANTY

At Jayco, we build our RVs to handle every adventure, then back them with our industry-leading 2+3 limited warranty. Our 2-year limited warranty has you covered for 2 camping seasons. That's 730 days. In addition, our 3-year structural limited warranty has you covered for 3 camping seasons or 1,095 days. You won't find a better limited warranty in the business, because the only strings that we attach are those that deliver the ultimate in reliability. That's the Jayco difference. So go explore. For a copy of our 2-year limited + 3-year limited structural warranty with complete terms and conditions, please contact your local Jayco dealer.



Scan QR code for specification definitions



Generations of family fun.